

HUBRIS THEATRE COMPANY
SAGE THEATER

A CLOCKWORK ORANGE

by:	ANTHONY BURGESS
Director:	JOHN BATEMAN
Lighting Designer:	CINDY SHUMSEY
Costume Designer:	ELIZABETH KIRBY
Video Designer:	SHACHAR LANGLEY

SCOTT TEDMON-JONES



THESE DRAWINGS AND THE IDEAS, ARRANGEMENTS, DESIGNS AND LANDSCAPES CONTAINED HEREIN OR REPRESENTED THEREBY ARE UNOWNED AND REMAIN THE PROPERTY OF STUART EDMOND-JONES. NO OTHER PERSONS HAVE BEEN GIVEN ANY AUTHORITY OR PERMISSION TO CONNECT WITH THE PROJECT SPECIFIED, NEITHER THIS DRAWING, NOR ANY OF SUCH IDEAS, ARRANGEMENTS, DESIGNS OR PLANS SHALL BE APPROPRIATED BY OR DISCLOSED TO ANY OTHER PERSON OR ORGANIZATION OF ANY KIND, WITHOUT THE WRITTEN PERMISSION OF STUART EDMOND-JONES.

THESE DRAWINGS REPRESENT VISUAL CONCEPTS AND CONSTRUCTION SUGGESTIONS ONLY. THE DESIGNER IS NOT QUALIFIED TO DETERMINE THE STRUCTURAL APPROPRIATENESS OF ANY DESIGN OR DESIGN ELEMENT, NOR THE RESPONSIBILITY FOR IMPROPER ENGINEERING, CONSTRUCTION AND/OR HANDLING OF THE SCENERY REPRESENTED HEREIN.

REVISIONS:

2/9:	CUT DSR/DSL STEP PLUGS
2/11:	UPDATED STAGE DIMENSIONS

DRAFTED BY:
SCOTT TEDMON-JONES

DATE:
SEPTEMBER 11, 2015

SCALE:	$1/2" = 1' - 0"$
PLATE:	

1

GROUND PLAN &
SL CL SECTION

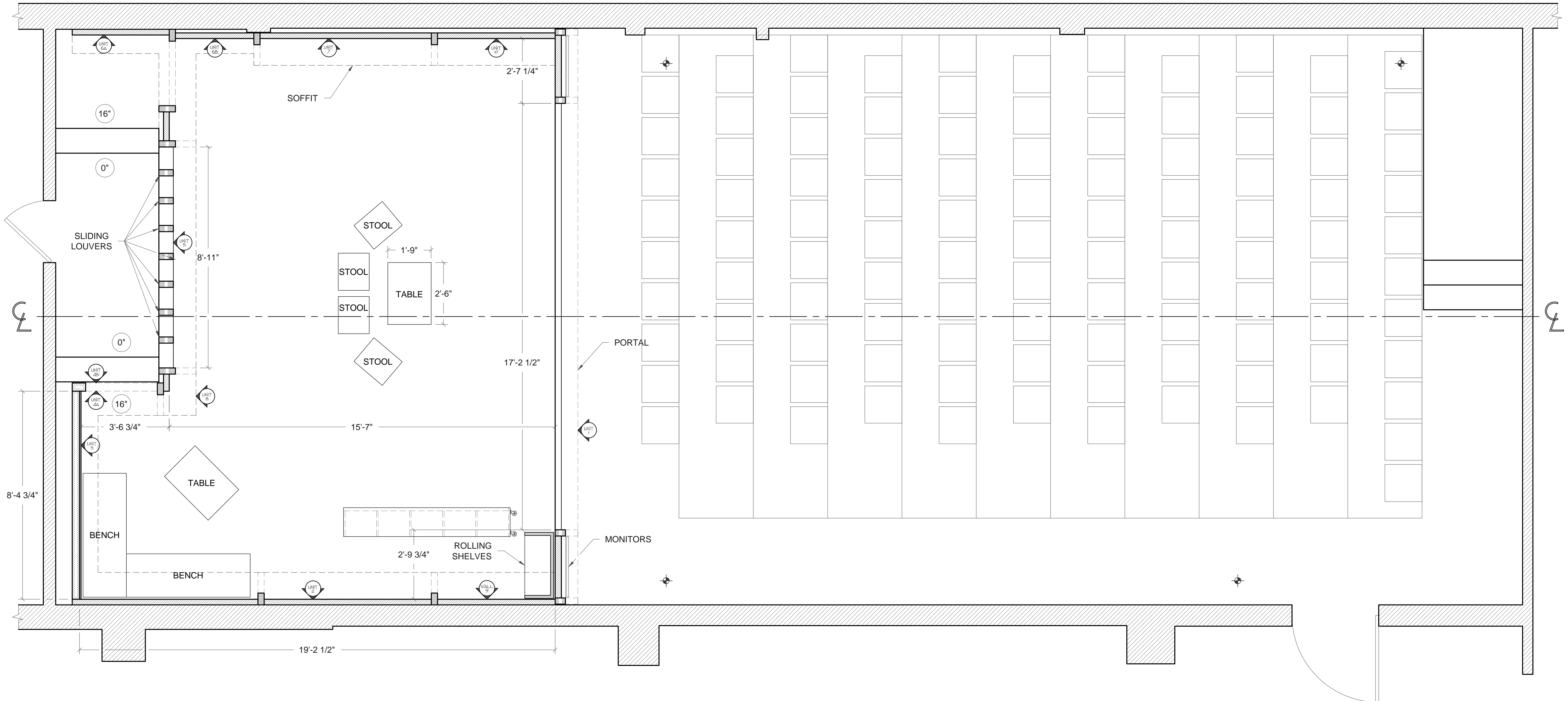
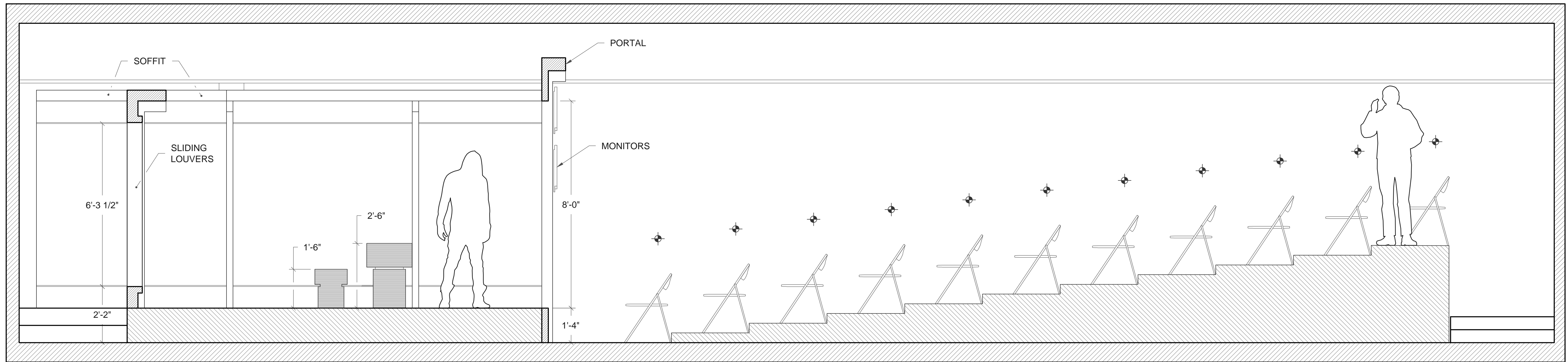

NOTES:
CONFIRMATION OF THE GRID LAYOUT IS NEEDED BEFORE THE PORTAL IS BUILT.
THE EXISTING STAGE DECK WILL BE USED. PRODUCTION WILL CONFIRM THAT IT CAN BE PAINTED.

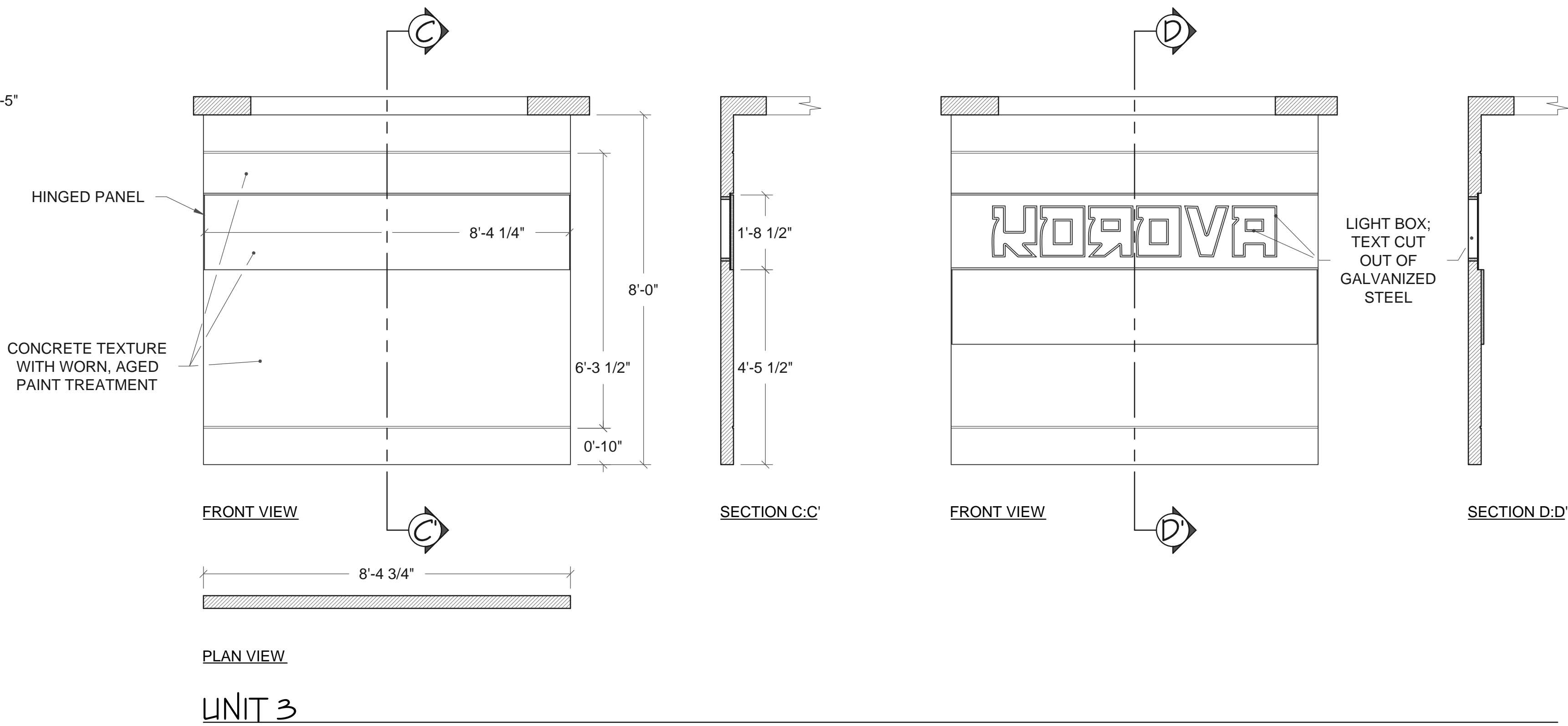
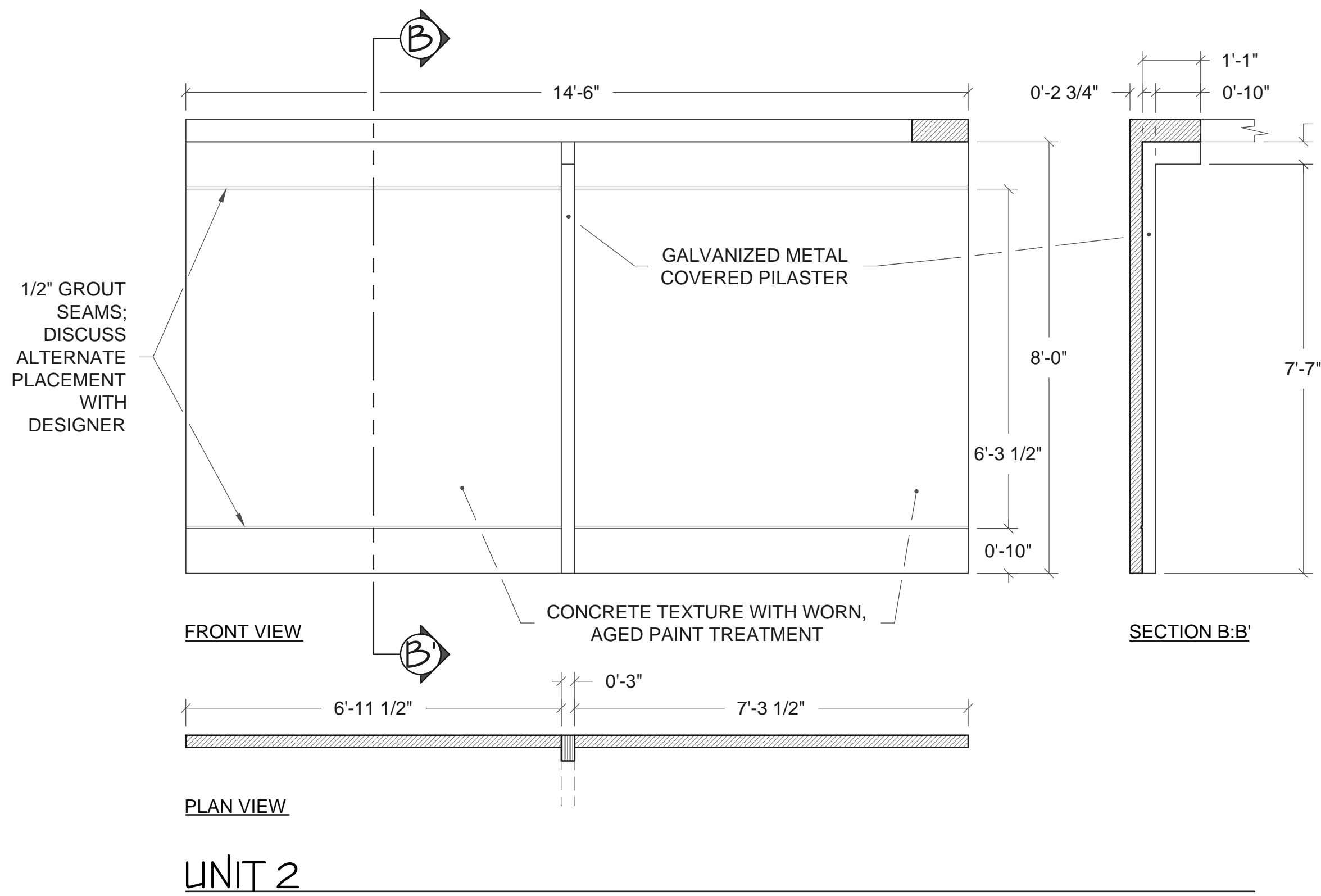
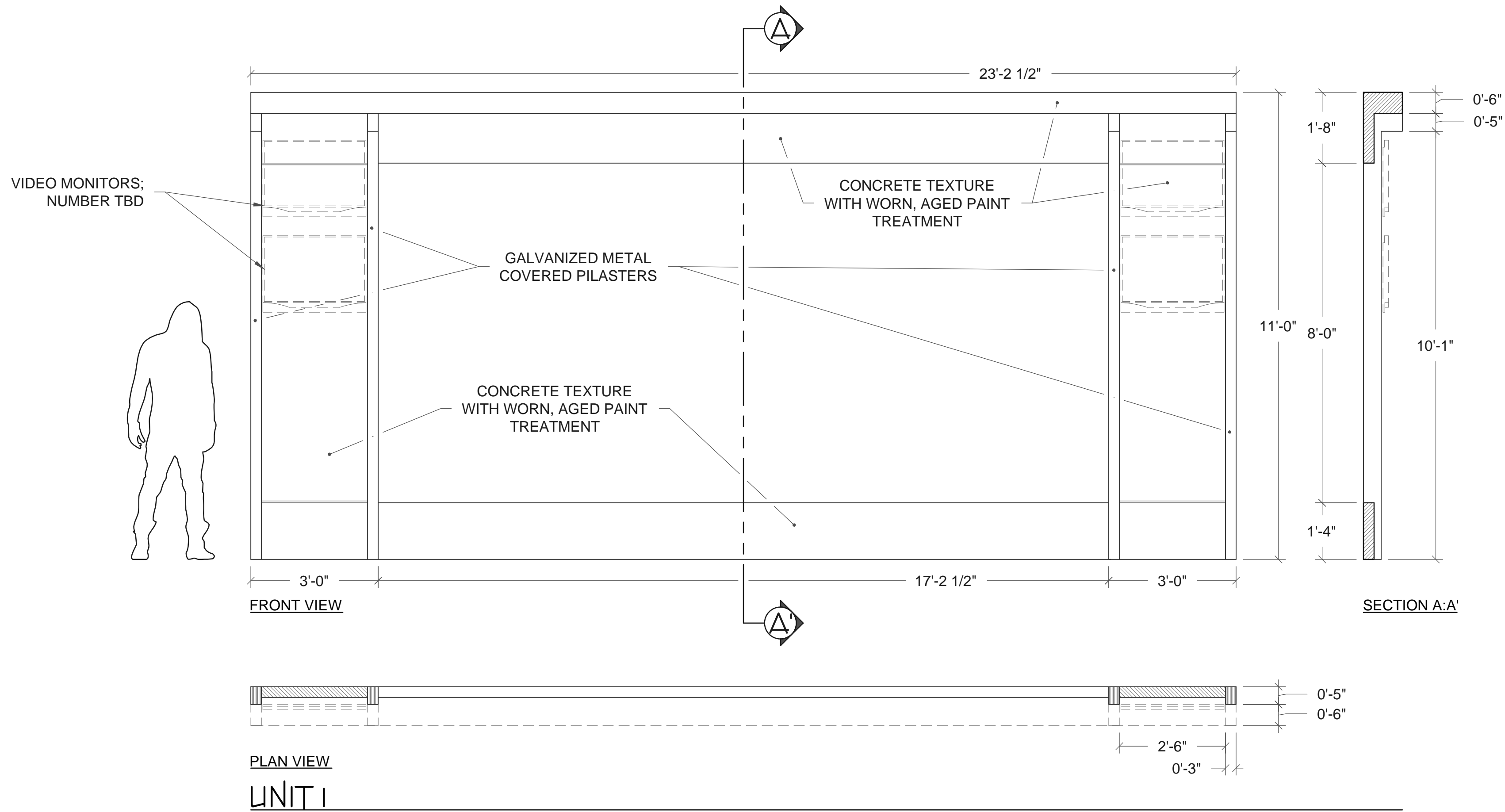
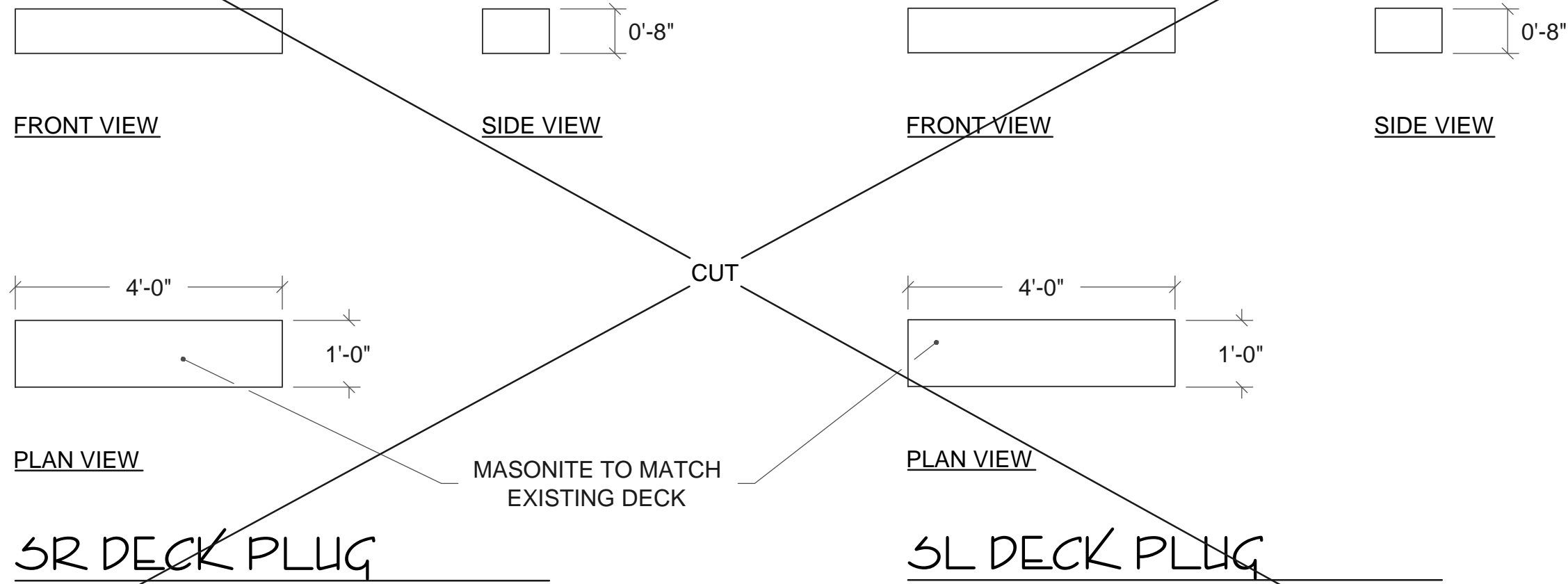

BUILD

HUBRIS THEATRE COMPANY
SAGE THEATER

A CLOCKWORK ORANGE

By:

ANTHONY BURGESS

Director:

JOHN BATEMAN

Lighting Designer:

CINDY SHUMSEY

Costume Designer:

ELIZABETH KIRBY

Video Designer:

SHACHAR LANGLEY

SCOTT TEDMON-JONES

SCOTT@STDESIGN.COM 412.740.4474 WWW.STDESIGN.COM

THE DRAWING AND THE IDEAS, ARRANGEMENTS, DESIGNS AND PLANS CONTAINED HEREIN OR REPRESENTED THEREBY ARE OWNED AND REMAIN THE PROPERTY OF SCOTT TEDMON-JONES AND HAVE BEEN CREATED AND DEVELOPED FOR USE ONLY AND IN CONNECTION WITH THE PROJECT SPECIFIED. NEITHER THE DRAWING NOR ANY OF SUCH IDEAS, ARRANGEMENTS, DESIGNS OR PLANS SHALL BE APPROPRIATED BY OR DISCLOSED TO ANY PERSON OR FIRM FOR ANY USE WHATSOEVER, EXCEPT BY WRITTEN PERMISSION OF SCOTT TEDMON-JONES.

THESE DRAWINGS REPRESENT VISUAL CONCEPTS AND CONSTRUCTION SUGGESTIONS ONLY. THE DESIGNER IS NOT QUALIFIED TO DETERMINE THE STRUCTURAL APPROPRIATENESS OF THESE DESIGNS, AND WILL NOT ASSUME RESPONSIBILITY FOR IMPROPER ENGINEERING, CONSTRUCTION AND/OR HANDLING OF THE SCENERY REPRESENTED HEREIN.

REVISIONS:

9/9: UPDATED LIGHT BOX TEXT

9/11: NO CHANGES

DRAFTED BY:

SCOTT TEDMON-JONES

DATE:

SEPTEMBER 11, 2015

SCALE:

1/2" = 1' - 0"

PLATE:

2

OF 5

ELEVATIONS

UNITS 1 - 3

A CLOCKWORK ORANGE

By: ANTHONY BURGESS
Director: JOHN BATEMAN
Lighting Designer: CINDY SHUMSEY
Costume Designer: ELIZABETH KIRBY
Video Designer: SHACHAR LANGLEY

SCOTT TEDMON-JONES

SCOTT@TEDMON-JONES.COM 412-740-4474 WWW.STEDMON-JONES.COM



THIS DRAWING AND THE IDEAS, ARRANGEMENTS, DESIGNS AND PLANS CONTAINED HEREIN OR REPRESENTED THEREBY ARE OWNED AND REMAIN THE PROPERTY OF SCOTT TEDMON-JONES AND HAVE BEEN CREATED AND DEVELOPED FOR USE ONLY IN CONNECTION WITH THE PROJECT SPECIFIED. NEITHER THE DRAWING NOR ANY OF SUCH IDEAS, ARRANGEMENTS, DESIGNS OR PLANS SHALL BE APPROPRIATED BY OR DISCLOSED TO ANY PERSON OR FIRM FOR ANY USE WHATSOEVER, EXCEPT BY WRITTEN PERMISSION OF SCOTT TEDMON-JONES.

THESE DRAWINGS REPRESENT VISUAL CONCEPTS AND CONSTRUCTION SUGGESTIONS ONLY. THE DESIGNER IS NOT QUALIFIED TO DETERMINE THE STRUCTURAL APPROPRIATENESS OF THESE DESIGNS, AND WILL NOT ASSUME RESPONSIBILITY FOR IMPROPER ENGINEERING, CONSTRUCTION AND/OR HANDLING OF THE SCENERY REPRESENTED HEREIN.

REVISIONS:
9/9: NO CHANGES
9/11: ADJUSTED UNIT 6
CHANGED UNIT 6 TO
6A/6B

DRAFTED BY:
SCOTT TEDMON-JONES
DATE:
SEPTEMBER 11, 2015

SCALE:
1/2" = 1' - 0"
PLATE:

3

OF 5

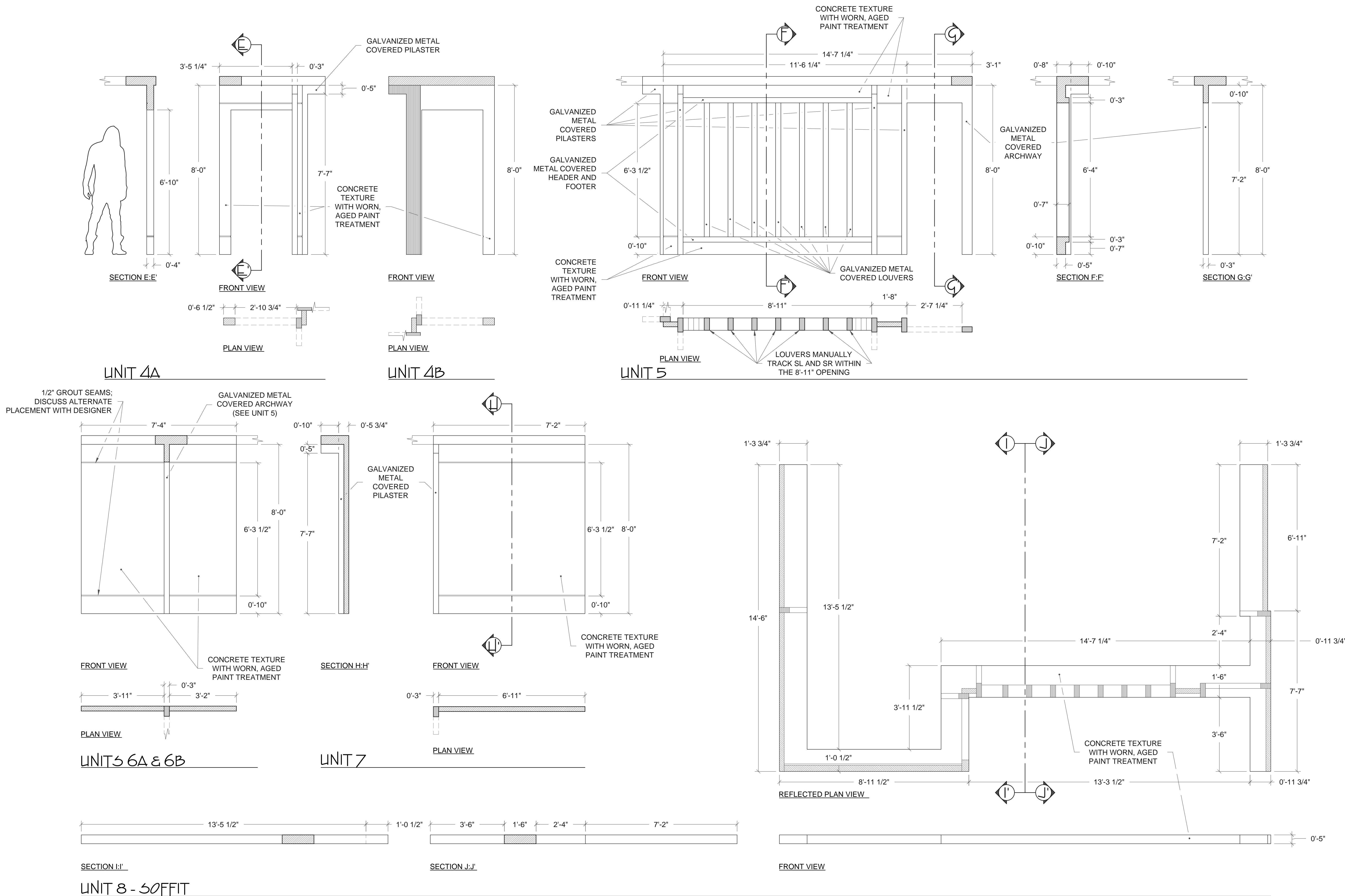
ELEVATIONS
UNITS 4 - 8

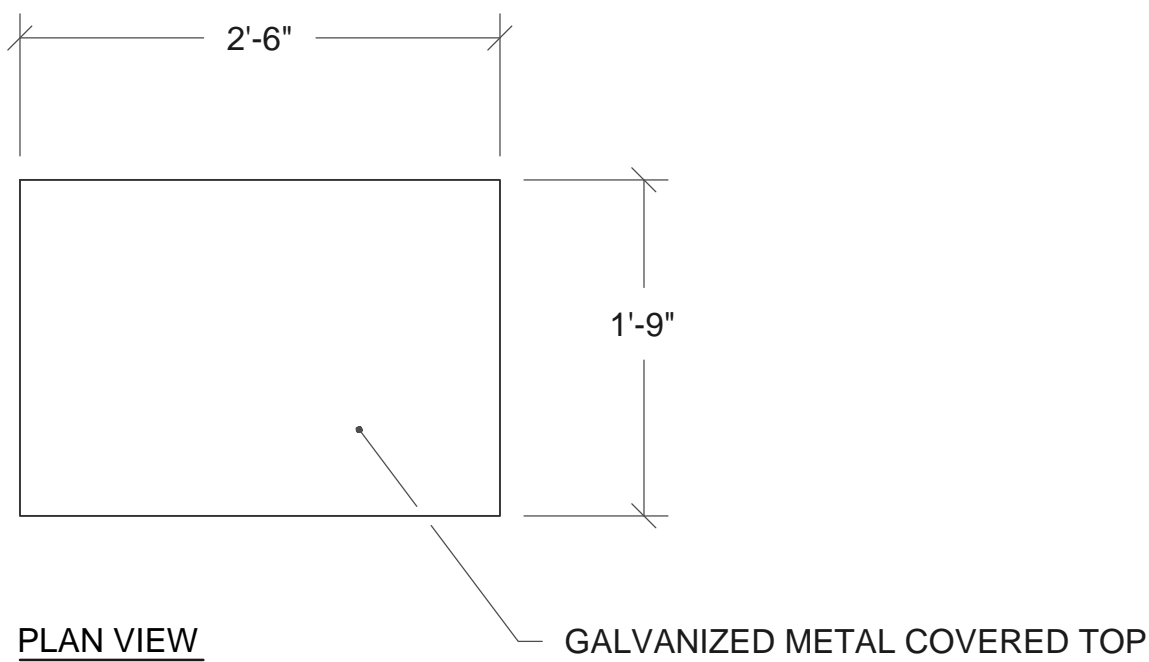
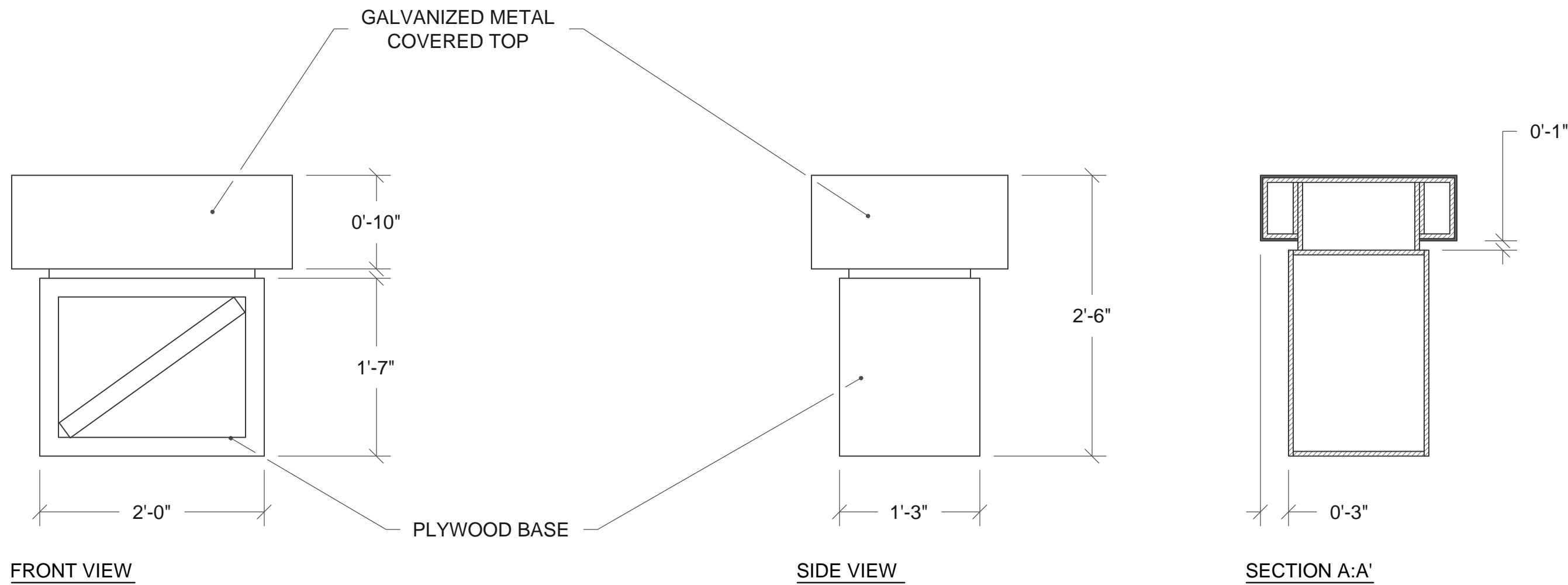

TABLES
MAKE TWO (2)

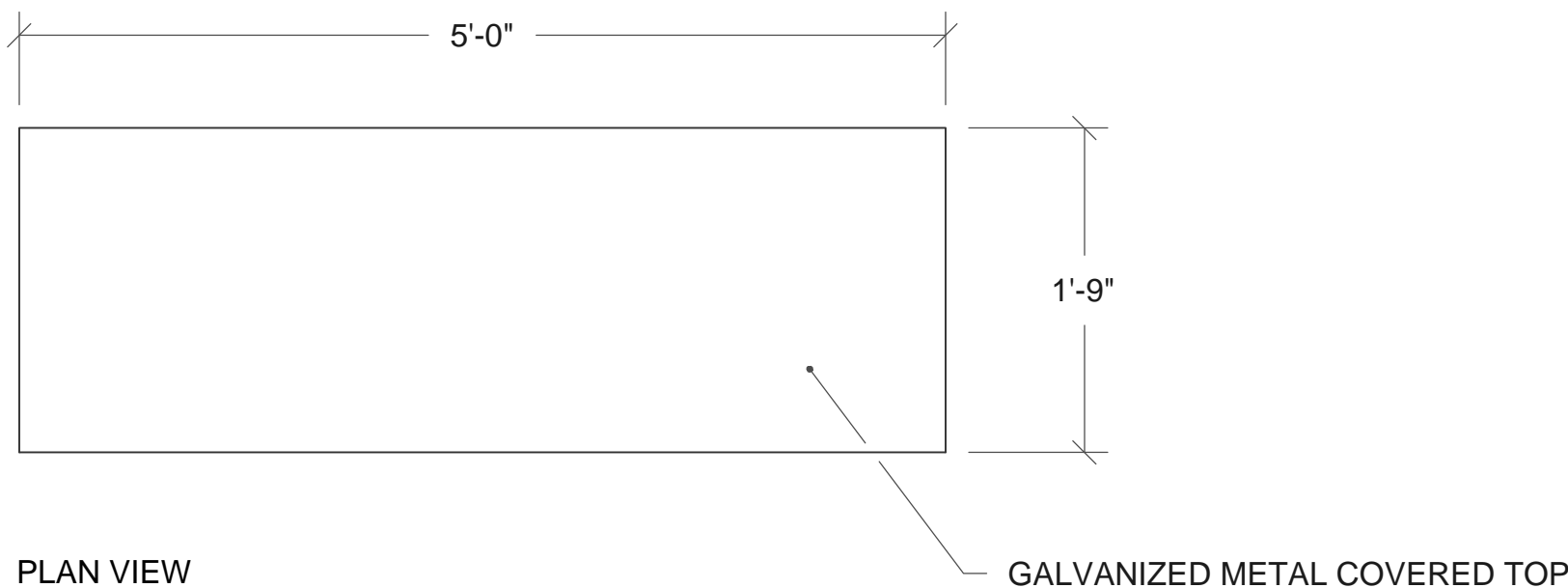
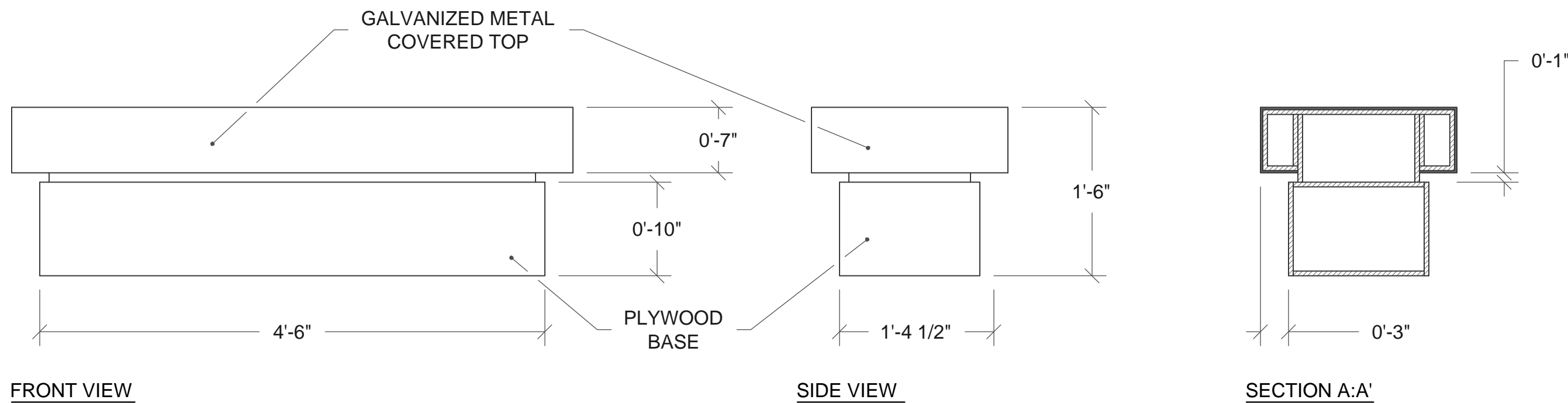

BENCHES
MAKE THREE (2)

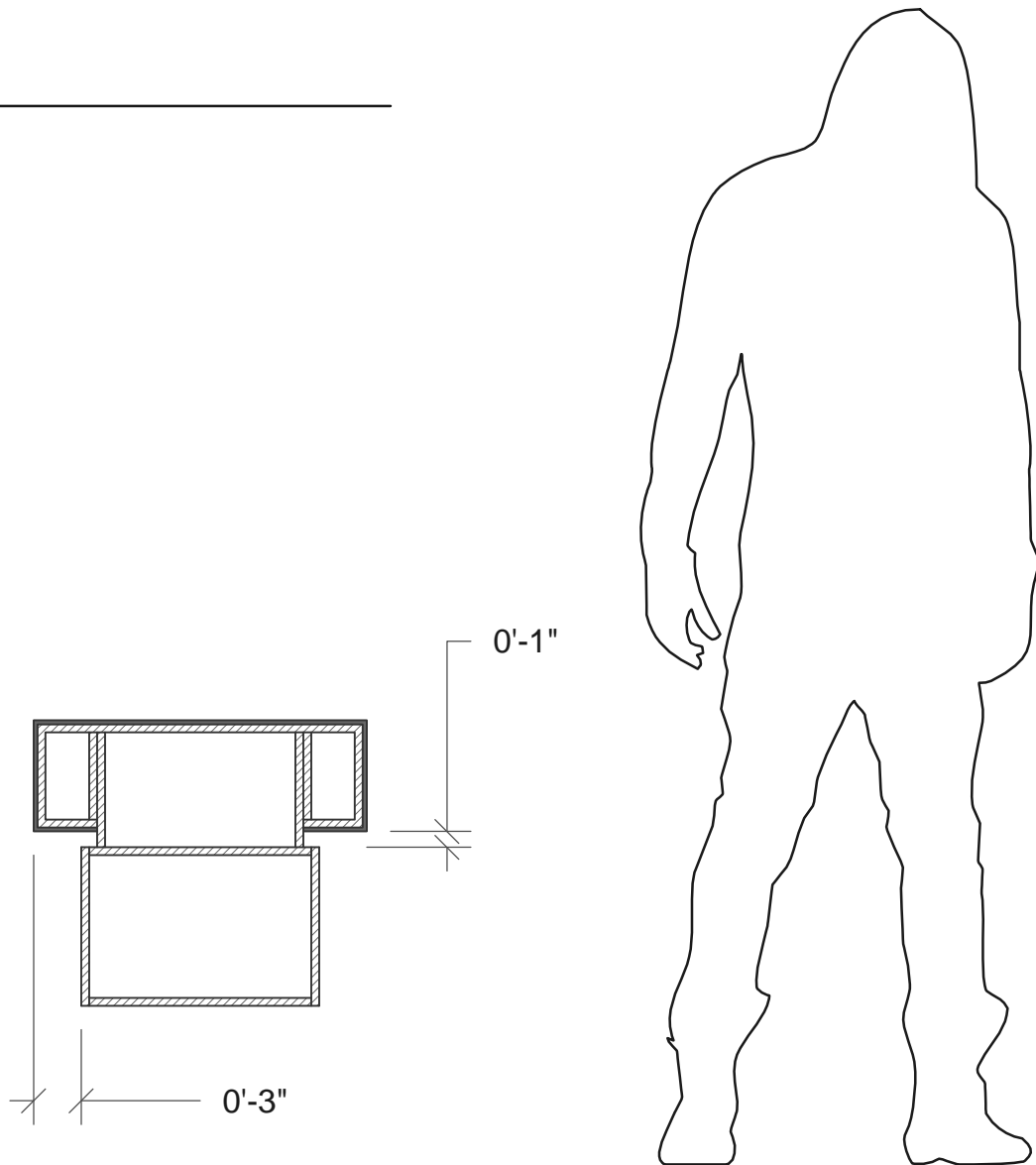

NOTE:
FURNITURE PIECES ARE MOVED BY CAST AND SHOULD BE AS LIGHT AS POSSIBLE.

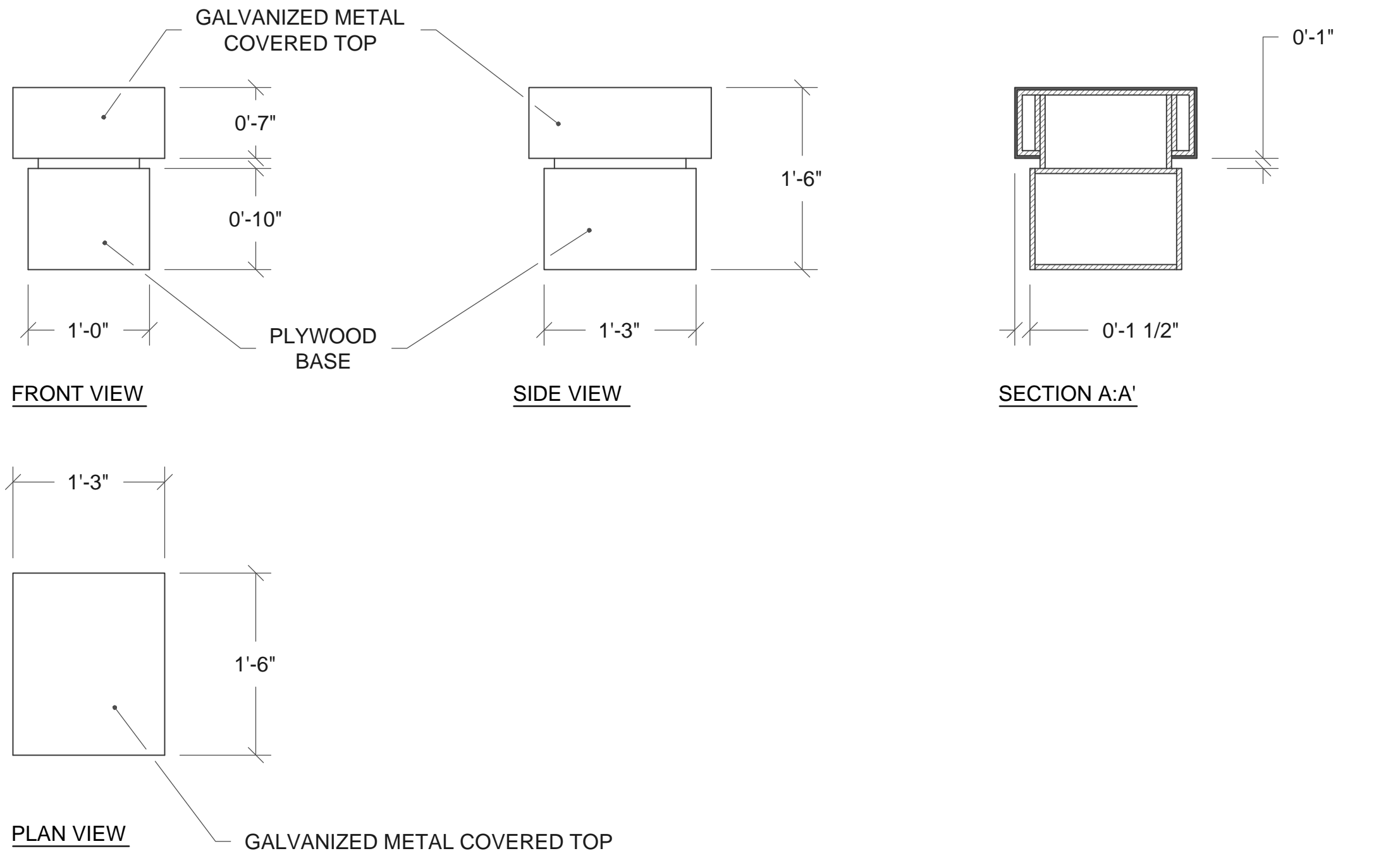

STOOLS
MAKE FOUR (4)

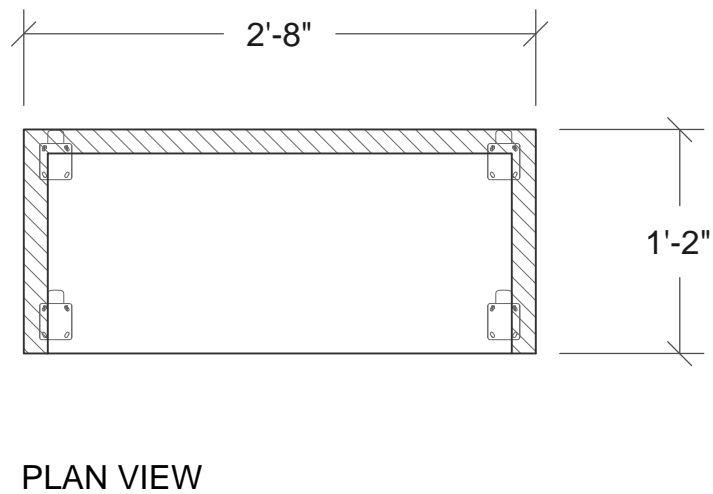
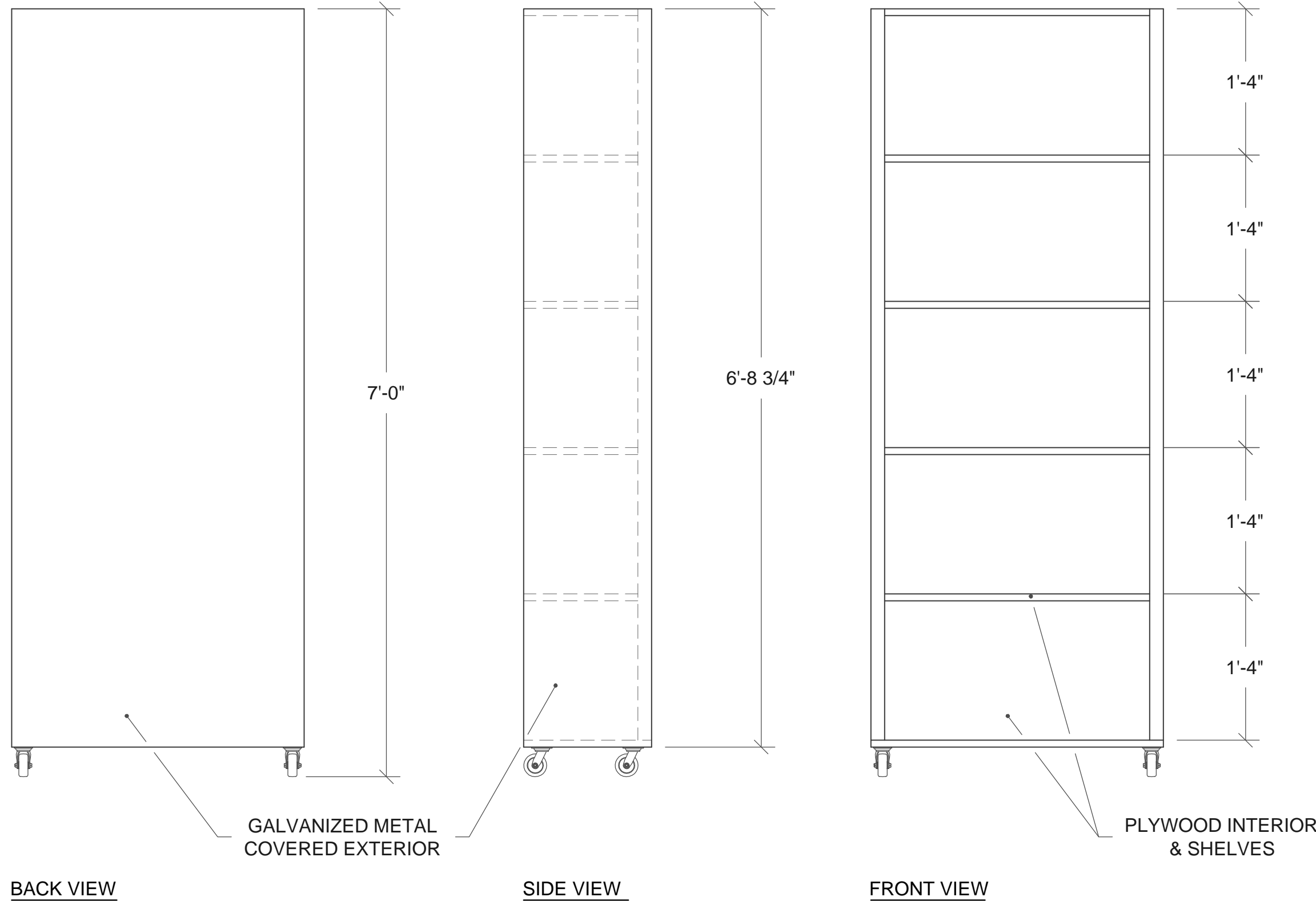

ROLLING SHELVES
MAKE ONE (1)

BUILD

HUBRIS THEATRE COMPANY
SAGE THEATER

A CLOCKWORK ORANGE

By:

ANTHONY BURGESS

Director:

JOHN BATEMAN

Lighting Designer:

CINDY SHUMSEY

Costume Designer:

ELIZABETH KIRBY

Video Designer:

SHACHAR LANGLEY

SCOTT TEDMON-JONES

SCOTT@STDESIGN.COM 412-740-4474 WWW.STDESIGN.COM

THIS DRAWING AND THE IDEAS, ARRANGEMENTS, DESIGNS AND PLANS CONTAINED HEREIN OR REPRESENTED THEREBY ARE OWNED AND REMAIN THE PROPERTY OF SCOTT TEDMON-JONES AND HAVE BEEN CREATED AND DEVELOPED FOR USE ON, AND IN CONNECTION WITH, THE PROJECT SPECIFIED. NEITHER THE DRAWING NOR ANY OF SUCH IDEAS, ARRANGEMENTS, DESIGNS OR PLANS SHALL BE APPROPRIATED BY OR DISCLOSED TO ANY PERSON OR FIRM FOR ANY USE WHATSOEVER, EXCEPT BY WRITTEN PERMISSION OF SCOTT TEDMON-JONES.

THESE DRAWINGS REPRESENT VISUAL CONCEPTS AND CONSTRUCTION SUGGESTIONS ONLY. THE DESIGNER IS NOT QUALIFIED TO DETERMINE THE STRUCTURAL APPROPRIATENESS OF THESE DESIGNS, AND WILL NOT ASSUME RESPONSIBILITY FOR IMPROPER ENGINEERING, CONSTRUCTION AND/OR HANDLING OF THE SCENERY REPRESENTED HEREIN.

REVISIONS:

9/9: MAKE TWO BENCHES
INSTEAD OF THREE

THE THIRD BENCH IS NOW
FOUR STOOLS

DRAFTED BY:

SCOTT TEDMON-JONES

DATE:

SEPTEMBER 11, 2015

SCALE:

1" = 1' - 0"

PLATE:

4

OF 5

FURNITURE
ELEVATIONS

A CLOCKWORK ORANGE

by:	ANTHONY BURGESS
Director:	JOHN BATEMAN
Lighting Designer:	CINDY SHUMSEY
Costume Designer:	ELIZABETH KIRBY
Video Designer:	SHACHAR LANGLEY

SCOTT TEDMON-JONES



THESE DRAWINGS AND THE IDEAS, ARRANGEMENTS, DESIGNS AND LANDSCAPES CONTAINED HEREIN OR REPRESENTED THEREBY ARE UNPUBLISHED AND REMAIN THE PROPERTY OF STAFFORD JEDMON-JONES. NO PART OF THESE DRAWINGS OR ANY OF THE IDEAS, ARRANGEMENTS, DESIGNS OR LANDSCAPES HEREIN HAVE BEEN OR SHALL BE IN ANY MANNER IN CONNECTION WITH THE PROJECT SPECIFIED, NEITHER THIS DRAWING, NOR ANY OF SUCH IDEAS, ARRANGEMENTS, DESIGNS OR LANDSCAPES SHALL BE APPROPRIATED BY OR DISCLOSED TO ANY OTHER PERSON OR ORGANIZATION OR BY ANY MEANS, WITHOUT THE WRITTEN PERMISSION OF STAFFORD JEDMON-JONES.

THESE DRAWINGS REPRESENT VISUAL CONCEPTS AND CONSTRUCTION SUGGESTIONS ONLY. THE DESIGNER IS NOT QUALIFIED TO DETERMINE THE STRUCTURAL APPROPRIATENESS OF ANY DESIGN OR DESIGN ELEMENTS AND IS NOT RESPONSIBLE FOR ANY IMPROPER ENGINEERING, CONSTRUCTION AND/OR HANDLING OF THE SCENERY REPRESENTED HEREIN.

REVISIONS:

9/11: ADDED UNITS 9 AND 10

DRAFTED BY:	SCOTT TEDMON-JONES
DATE:	SEPTEMBER 11, 2015

SCALE: $1/2" = 1' - 0"$

PLATE:

5

OF 5

ELEVATIONS

UNITS 9-10

